

IMPORTANT NOTE: VERIFY BOOTH DESIGN IS COMPATIBLE WITH ON SITE CONDITIONS FOR PROPER ACCESSIBILITY.

CASHIER WINDOW AVAILABLE IN SLIDING DOOR OR WALL.

PLAN VIEW

STANDARD ITEMS FOR A DISABLED ACCESSIBLE R17088SL DURALUMINUM BUILDING (REFER TO DURALUMINUM SPECIFICATIONS FOR TYPICAL CONSTRUCTION)

- ① 100 AMP SINGLE PHASE 12 CIRCUIT MAIN LOAD CENTER
- ② 115V DUPLEX, 230V OUTLET
- ③ 80 WATT LIGHT FIXTURE W/SWITCH
- ④ 40 WATT LIGHT FIXTURE W/SWITCH
- ⑤ 22" DEEP SHELF
- ⑥ 3" OVERHANG EXTERIOR ROOF (OPTIONAL)

STANDARD FEATURES DESIGNED INTO BOOTH TO MEET ADA GUIDELINES.



- \* MANEUVER WITHIN BOOTH- 60" DIAMETER
- \* DOOR CLEARANCES- 32" CLEAR OPENING, 1/2" HIGH THRESHOLD
- \* SHELF- 32" A.F.F.
- \* CASHIER WINDOW- 32" A.F.F.
- \* CEILING HEIGHT- 80"

{ACCESSIBLE ROUTE TO BOOTH- BOOTH CAN BE DESIGNED TO MEET ON SITE CONDITIONS, EXAMPLE; DOOR LOCATION AND THRESHOLD HEIGHT}

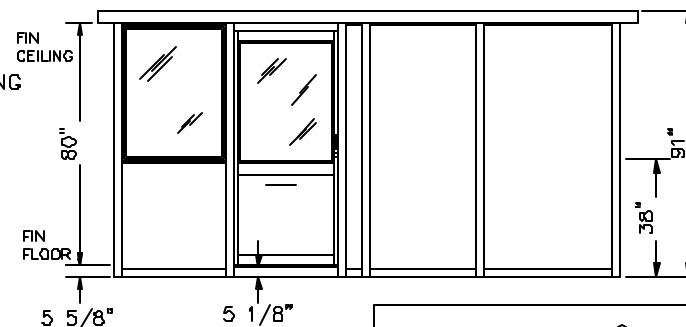

ELEVATION A

PORTA-KING BUILDING SYSTEMS

4133 SHORELINE DRIVE EARTH CITY, MISSOURI 63045  
1-800-456-5464 FAX 314-291-2857 www.portaking.com

TITLE

DURALUMINUM MODEL DAR17088SL